

# OWNER'S MANUAL

## STS-EZ-AUTOBATCH

(STS - Smart Transfer Systems for chemical and surfactant induction.)

**Model: 5283376**

STS-EZ AUTOBATCH 100

1" Single Product EZ-AUTOBATCH System



**Model: 5283377**

STS-EZ AUTOBATCH 150

1-1/2" Single Product EZ-AUTOBATCH System



**BEFORE RETURNING THIS PRODUCT  
FOR ANY REASON, PLEASE CALL**

<b>BAKERSFIELD, CA</b> 877-724-2236	<b>COLUMBUS, NE</b> 800-274-1025	<b>DOTHAN, AL</b> 800-227-4098
<b>FARGO, ND</b> 701-280-2862	<b>HOPKINSVILLE, KY</b> 800-637-7172	<b>MANKATO, MN</b> 507-388-6295
<b>NEWTON, KS</b> 800-394-7662	<b>PASCO, WA</b> 800-634-2026	<b>PHOENIX, AZ</b> 877-974-7166

**SOUTH CHARLESTON, OH**  
937-620-1710

If you should have a question or experience a problem with your Ag Spray Product: Visit our website @ [www.agspray.com](http://www.agspray.com) or call the Toll free number above. Our technical support representatives will be happy to help you.

In most cases a customer service rep. can resolve the problem over the phone.

To obtain prompt, efficient service, always remember to give the following information....

- Correct Part Description and/or part number
- Model number and Serial Number

Retain a copy of your receipt for your unit,  
as it will be required to validate any warranty service

Products are warranted against manufacturer or workmanship defects for  
one year from date of purchase for home owner  
usage and 90 days for commercial usage.

### General Information

Thank you for purchasing this product. The purpose of this manual is to assist you in operating and maintaining your newly purchased product.



**WARNING:** To reduce the risk of injury, the user must read and understand the operator's manual before using this product.



**WARNING:** Cancer and Reproductive Harm  
[www.P65Warnings.ca.gov](http://www.P65Warnings.ca.gov)



[www.agspray.com](http://www.agspray.com)

[5196277

(02/26)]

## Table of Contents

3-4	Operation & Safety Information
5-14	Installation & Basic Operations Instructions
15-17	STS-EZ-AUTOBATCH Wiring
18	Operation Principles
19	STS-EZ-AUTOBATCH System Operation
20	STS-EZ-AUTOBATCH-100 System (5283376) Breakdown
21	STS-EZ-AUTOBATCH-150 System (5283377) Breakdown
22	Limited Warranty

## Important Operation & Safety Information

### **WARNING**

Read and understand **this owner's manual** completely before using the Meter System.  
Read each **chemical label's instructions** before handling the chemical.

*Improper use of the meter or handling of chemicals could result in serious injury or illness for the operator or nearby persons/animals, or cause damage to the environment.*

**\*\*Test Calibration Before Use!!\*\***

**LISTED BELOW** is a summary of safety information of particular importance. See individual sections of this owner's manual for more details.

#### ----- **BEFORE YOU BEGIN** -----



Please read and understand this manual and its instructions and warnings completely before operating the Inductor.

- **Be aware of all safety guidelines, warnings and cautions including those of the pump manufacturer.**
- **Read and understand the chemical manufacturer's labels, warnings and instructions.**
- **Know and fulfill all state pesticide applicator license requirements.**
- **Familiarize yourself and other operators with the Meter System's components and how all parts are operated.**

#### ----- **General Safety Guidelines** -----



Every year many unnecessary accidents occur do to improper equipment handling and a disregard for safety precautions. You, the operator, can avoid accidents by observing the precautions in this section.

- The operator should be a responsible adult. Do not allow persons to operate this Meter System until they have displayed a thorough understanding of the safety precautions and operational use!
- All operators must also fulfill state pesticide applicator license requirements.
- Never attempt to operate this Meter System when under the influence of alcohol or drugs.

#### ----- **Before Operation** -----



- Carefully study and understand the owner's manual.
- Read and follow chemical manufacturer's labels, warnings and instructions! A material safety data sheet (MSDS) should be provided by the chemical manufacturer.
- To avoid injury from chemical hazards, wear the proper protective clothing. Each chemical manufacturer's clothing requirements are listed under the "Personal Protective Equipment (PPE)" section in the chemical instructions.
- Before adding chemicals, have all operators practice operating the Meter System (clean water only) and it's attachments until all operators are completely capable of safe operation.

## BEFORE SEASONAL USE





- **CHECK and TEST Meter System with water before adding chemical.** Temperature change can cause material fitting expansion/contraction. Serious injury could result from chemical leaks.
- **REPLACE** any worn or frayed hoses. Hose failure can result in serious damage.
- **INSPECT** digital display. Insure the display is luminated. Failure to have a properly functioning display can result in miss applications of chemical. See pages 8 - 14 for display instructions.

## General Chemical Safety



- **READ and FOLLOW** all chemical label's instructions and warnings.
- **AVOID** inhaling, ingesting or coming into contact with any chemicals.
- **KNOW** applicable licensing and regulatory requirements for the chemical you plan to use.
- **KNOW** emergency procedures before handling chemicals.
- **WEAR** protective clothing, eye protection and chemical resistant gloves when filling, using and cleaning the Meter System. Wear additional protective gear, such as facemask or apron, as recommended on the chemical label.
- **EXERCISE EXTRA CAUTION** around children or pets. Pesticides are especially toxic to them. Keep Meter System and spray materials away from them at all times.
- **DO NOT MIX OR POUR** chemicals in an enclosed, unvented area.
- **DO NOT USE** flammable or corrosive chemicals in the Meter System.
- **FLUSH** the Meter System with clean water after every use **AND** before switching chemicals.
- **STORE** pesticides in a correctly labeled container and in a secure location.
- **MONITOR** the health of operators frequently exposed to pesticides, as recommended by the chemical label or local/federal regulations.
- **CHECK** chemical compatibility with meter and other plumbing components.

 <b>CAUTION</b>	
PERSONAL PROTECTIVE CLOTHING TO BE WORN AT ALL TIMES WHEN HANDLING CHEMICALS	
	
WEAR APPROPRIATE HAND & EYE PROTECTION	

 <b>NOTICE</b>
Gallongage markers on the tank are for reference only. Check calibration before use.

 <b>WARNING</b>
DO NOT STORE OR TRANSPORT WITH LIQUID IN TANK

 <b>WARNING</b>
<b>TOXIC CHEMICAL HAZARD</b> To prevent serious injury or death:
<ul style="list-style-type: none"><li>• Handling Agriculture chemicals can be hazardous.</li><li>• Read &amp; follow the chemical manufacturers' instructions regarding the proper handling procedures and safety attire for the chemical being used.</li></ul>

# Installation & Basic Operation

The STS-EZ-AUTOBATCH System is designed to function as a stand alone chemical metering system. It can be added to any chemical mixing and metering system on either the suction side of the transfer pump OR pressure side utilizing a venturi system. As a stand-alone system you can add as many together as desired. Contact your nearest Ag Spray Equipment location if you have any questions on how to most efficiently plumb into your transfer system.

## Installation

Identify installation location in your plumbing system.

### **For Suction Side of Transfer Pump Installation:**

It is recommended to tie in to the carrier plumbing as close to transfer pump inlet as possible. This will result in the maximum vacuum suction for the EZ-AUTOBATCH product as possible. It is also recommended to have a valve with easy access placed between the carrier outlet and EZ-AUTOBATCH to allow the operator to close down and restrict the carrier flow to maximize chemical addition speed when needed, especially for the smaller batch loads when multiple products are being added. It is recommended to only close the valve partially to restrict the carrier flow, closing the valve to far will cause the transfer pump to cavitate and reduce pumping efficiency. A check valve (not included) is recommended to prevent backflow in case of transfer pump failure, gear meter is bi-directional and would count fluid flow both directions.

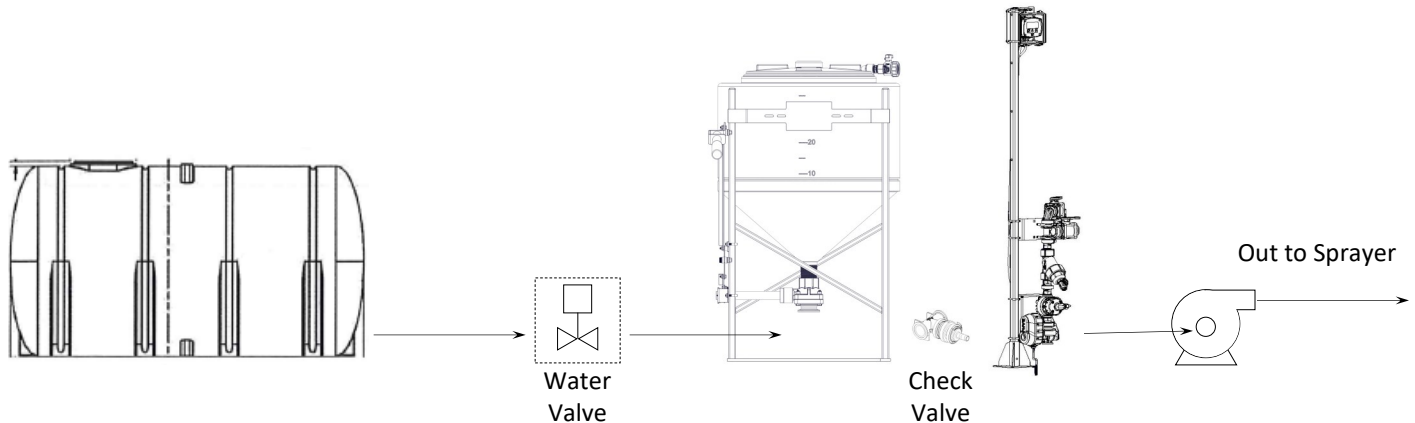

### **For Pressure Side of Transfer Pump with Venturi System Installtions:**

Plumb on the inlet side of the Venturi System. This can be with a tee or cross on an existing inductor system. NOTE that most Venturi Systems when operating at peak performance only have about 38-48 GPM induction rate. If you are tying multiple metering or auto-batch systems together, you can run them simultaneously, as long as the products are compatible. If using high volume metering systems such as STS-EZ METER HIGH VOLUME 1-1/2", running them at the same time could reduce the flow rate of each. A check valve (not included) is recommended to prevent backflow, gear meter is bi-directional and would count fluid flow both directions.

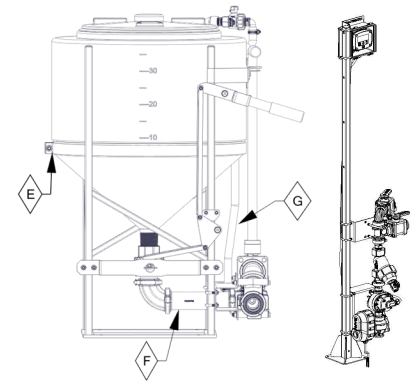

## Mounting

The EZ-AUTOBATCH stand comes with a baseplate (5283375-BLK) that is designed to be fastened to the bed or working area with (4) 3/8" bolts (not included) on each corner of the baseplate (5283375-BLK). Once the baseplate is bolted down, slide the support tube (5070521-BLK) in and secure with 5/16" carriage head bolt through the base and support tube and fasten with hex nut. Tighten set screw (5117343) to firmly secure the tube in place.

## 12VDC Power

The STS-EZ-AUTOBATCH system requires 12VDC power to operate the electric valve. This will also power the backlight in the display and illuminate the valve indicator on the top of the valve motor.

EZ-AUTOBATCH is supplied with 10' power cord (5277040) that includes an inline switch. Turn power off when not in use, otherwise the lights will draw power from 12VDC system. **The display (EB406-R) will remain on at all times powered by the internal 3.6V Lithium Thionyl Chloride battery.**

## Plumbing Installation and Operation:

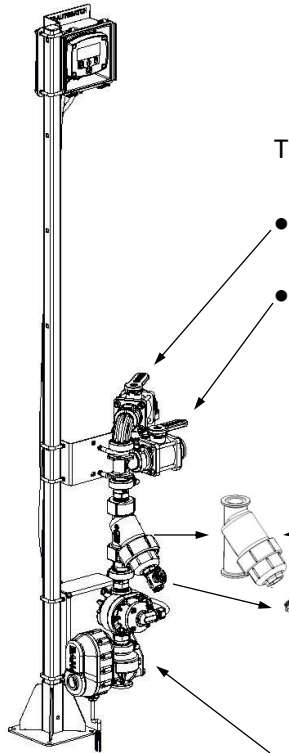

The STS-EZ-AUTOBATCH system 5283376 & 5283377 are plumbed for single chemical input.

Chemical inlet ball valve is located on the top of the column and is outfitted with a 1" male camlock fitting on 5283376, and a 2" male camlock fitting on 5283377.

The column rinse ball valve is located below the input valve and comes blank. End-user will need to supply the appropriate flange clamp, gasket and fitting to adapt to fresh water source.

**Recommended to rinse at the end of the day or between extended periods of non-use to prevent chemical settling in the strainer and meter. "Some products may require more frequent rinsing."**

\*Strainer with drain valve. (See below for strainer bowl drain valve operation).

Ball Valve

Outlet electric valve comes blank, end-user will need to supply flanged clamp, gasket and appropriate fitting to meet plumbing needs.

### \*Strainer Bowl Drain Valve Operation:

- **Unlock and Activate:** to open or close the valve, **pull up** on the handle and rotate it **90 degrees**.
- **Safety Feature:** The locking handle is designed to prevent accidental activation from bumps or crop contact in agricultural and industrial settings.
- **Tool-Free Design:** No tools are required for operation; the handle is oversized for easy manual gripping.

- **Orientation:** Like most ball valves, if the handle is **in line** with the valve, it is open; if it is **perpendicular** (crossed), it is closed.

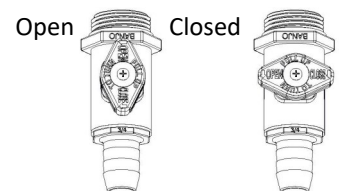

- **Clean Strainer Screen:** Once the strainer is drained, unscrew the strainer bowl to access the screen, inspect and clean with warm soapy water.
- **Make sure Strainer Drain Valve is in the closed position before use.**

## Connecting Power

### External DC Power

External DC power is required, 12V DC; this will provide the necessary power to operate the controller, switch the solenoid valve or mechanical relay, power the LCD backlight, and provide power for the sensor supply terminal.

Before DC power is connected to the batch controller, the LCD will be active, and the user will be able to enter configuration menus and setup their controller. The battery is only able to power the device for setup and does not provide enough power for operation.

### Sensor Supply

The instrument is equipped with a 12V regulated sensor supply terminal which is suitable for powering hall-effect sensors in FLOMEC flow meters. The sensor supply is only available when the instrument is connected to an external 12V DC supply, so while the controller is operating on backup battery, any flow meter sensors will not receive power.

### Battery Power

The EB40 is fitted with a Lithium Thionyl Chloride battery, which allows the user to configure the batch controller prior to electrical installation and will prevent loss of current values or batch progress in case of a power failure.

Once DC power is connected to the controller, the battery will go into standby as a backup power source. The battery is expected to have a lifetime of 8-10 years while in standby.

For battery replacement one of the below options is recommended, however any 3.6V Lithium Thionyl Chloride battery will be acceptable. Alkaline batteries or 3V lithium batteries are not suitable.

<p><b>Replacement 3.6V Lithium Thionyl Chloride Battery Part#: 1312125</b></p>
--

Other Acceptable:

Manufacturer	Model
Tekcell	SB-AA11
SAFT	LS14500
Tadiran	SL3605

**Use of a battery which is not a 3.6V Lithium Thionyl Chloride type will void the instrument warranty.**



## Automatic Over-run Compensation

The EB406R has an Automatic Over-run Compensation feature which will measure the amount of over-run on previous batch volumes and automatically adjust the close timing of the valve on subsequent batch volumes. Because of this feature, the batch controller can be expected to have accurate batch volumes from the second batch onwards.

Automatic Over-run Compensation will remember the compensation amount even after changing to a new batch preset value. So long as no physical changes are made to the system, the user should experience an accurate and consistent process. This feature can be turned off if it is not desired. If the user wishes to reset the compensation amount for any reason they may turn off compensation and turn it back on to reset it.

With batch processes that are subject to erratic or inconsistent conditions, it is possible that the Automatic Over-run Compensation feature will over-correct and exacerbate an already erratic process. In this case it is advisable to disable this feature.

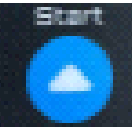
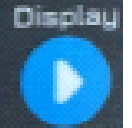
## Keypad Function

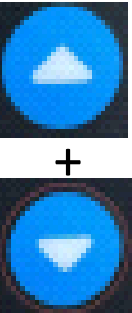
KEY	FUNCTION IN OPERATING MODE	FUNCTION IN MENUS
	A single press to display batch value, second press to change batch value, hold for 3 seconds to display firmware revision number and serial number below	<b>Enter key;</b> selects a program setting, or accepts an entered value
	Press once to start the batch or resume a paused batch.	<b>Up key;</b> moves upwards in an on-screen menu, or increments the selected digit when configuring a setting or entering a preset quantity.
	Toggles the bottom display line between preset quantity, flow rate, or accumulated total	<b>Right key;</b> moves digit selection to the right when configuring a setting or entering a preset quantity.
	If a batch is running, press once to pause the batch. If controller is paused or stopped, press once to reset and be ready to start a new batch	<b>Down key;</b> moves downwards in an on-screen menu, or decrements the selected digit when configuring a setting or entering a preset quantity.
	Press and hold both buttons simultaneously for a duration of 5 seconds to enter the on-screen configuration menu	No Function

## Enter a New Batch Preset

To enter a new batch preset, you first access the Batch Set Menu by pressing the **Batch/Enter** key. The first option in the menu is to enter a new batch preset. By using the arrow keys, the user can enter the desired quantity and then press the **Batch/Enter** key to accept.

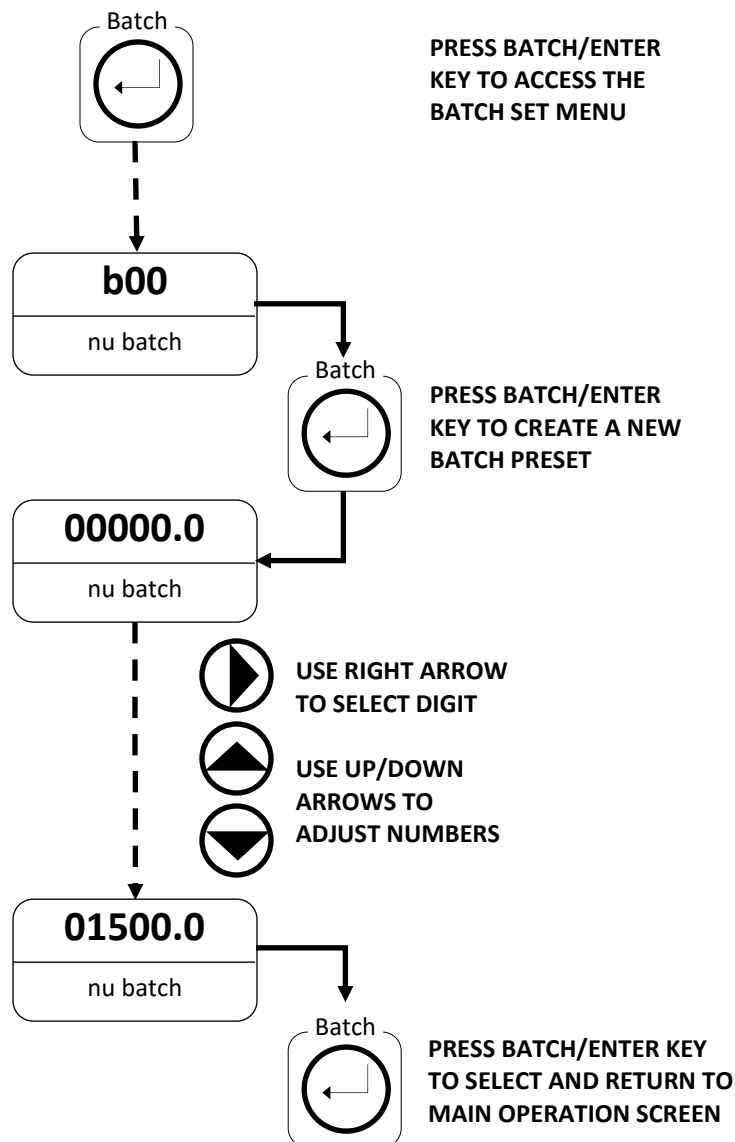

### Select a Common Batch Preset

Previously used batch presets can be selected for repeat usage. Access the menu by pressing the **Batch/Enter** key, and select from the available volumes using the **Up Arrow/Down Arrow** keys.

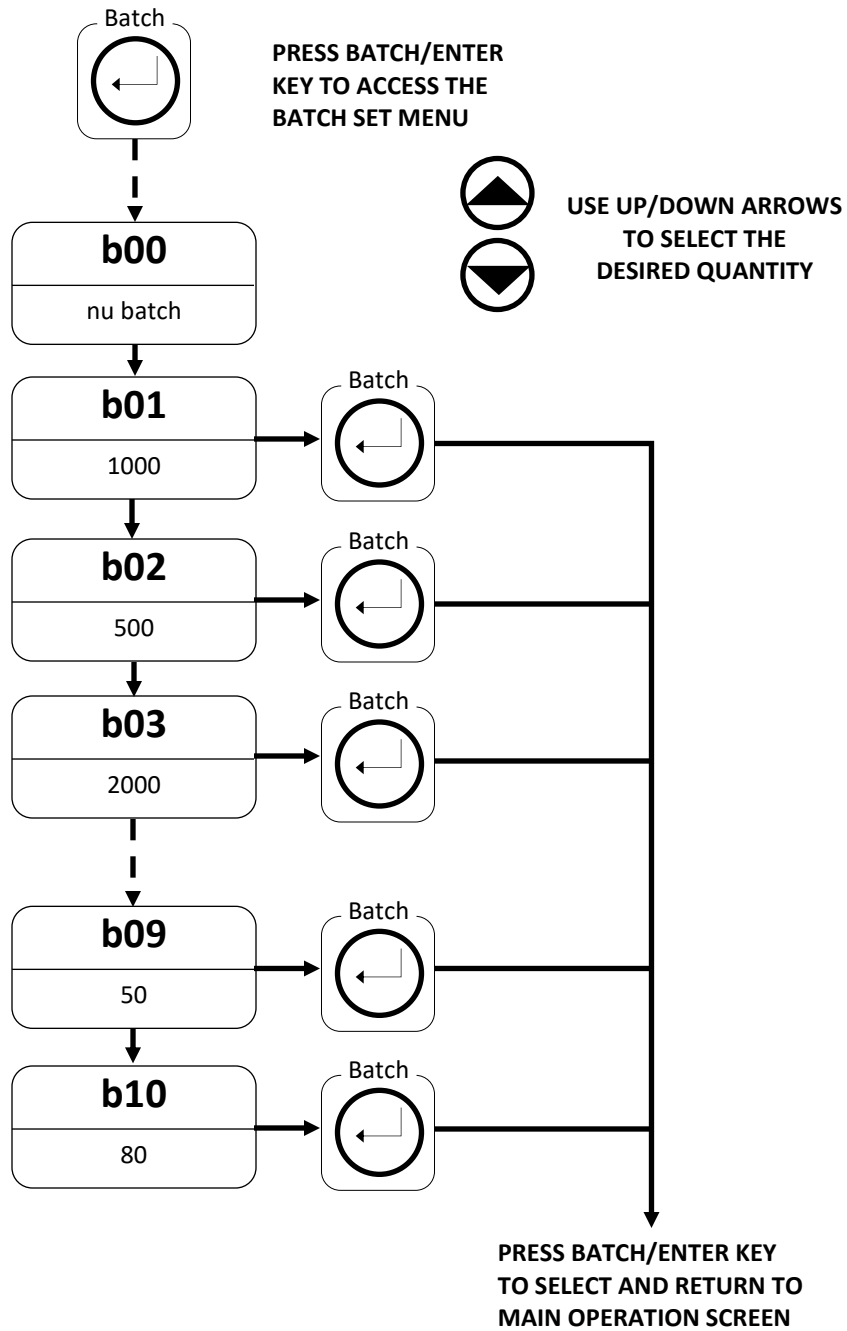

**Programming Flowchart**

**\*\*See Flomec EB40 Owners Manual for complete operation controls.**

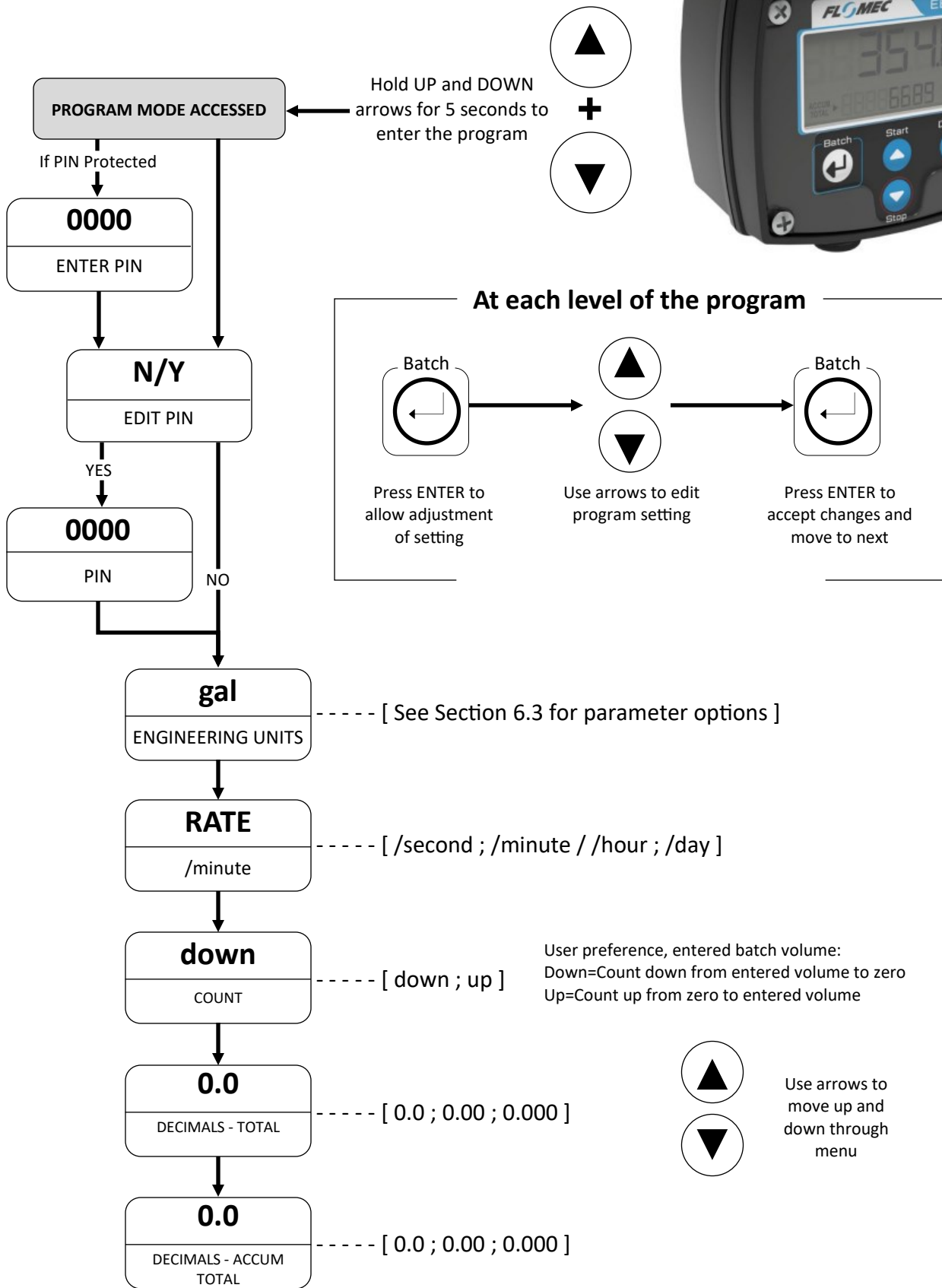

>>> From Previous Page

**0.0**  
DECIMALS - RATE

----- [ 0.0 ; 0.00 ; 0.000 ]

**HALL**  
SENSOR TYPE

----- [ REED ; HALL ; COIL ]

See section 5.6 for help selecting input parameters

**ENTER**  
CALIBRATION DATA

**FREQ.0**  
0001.0

**FACT.0**  
00106.272

**FREQ.1**  
0000.0

FREQ.0 enter a value of 1.0, this will then default to the FACT.0 to input flowmeter K Factor found on the Flowmeter Calibration Certificate. FREQ.1 enter all zero's. This lets the console know this is a single input system.

**It is very important to note that K-factors are always entered in units of Litres, regardless of the units chosen for the display.**

This meter is a single point of calibration, the frequency value is not important and any non-zero value can be entered here. After entering a non-zero value for frequency the K-factor for the flowmeter may be entered. **Please note, if there are no non-zero frequency values entered, the EB40 will operate as if the K-factor has been set to 1Pulses/Litre.**

(The K-Factor can be found on the Calibration sheet included with the manual. For the OM025P series 1" flow meter, the K-Factor will be a value around 106.272 Hall Effect Sensor.

For the OM040S 1½" flow meter, the K-Factor will be a value around 55.741 (Pulse/L) Hall Effect Sensor.

REMEMBER: CALIBRATION DATA IS ALWAYS ENTERED IN PULSES/LITRE

▶ Continue Over Page >>>

>>> From Previous Page

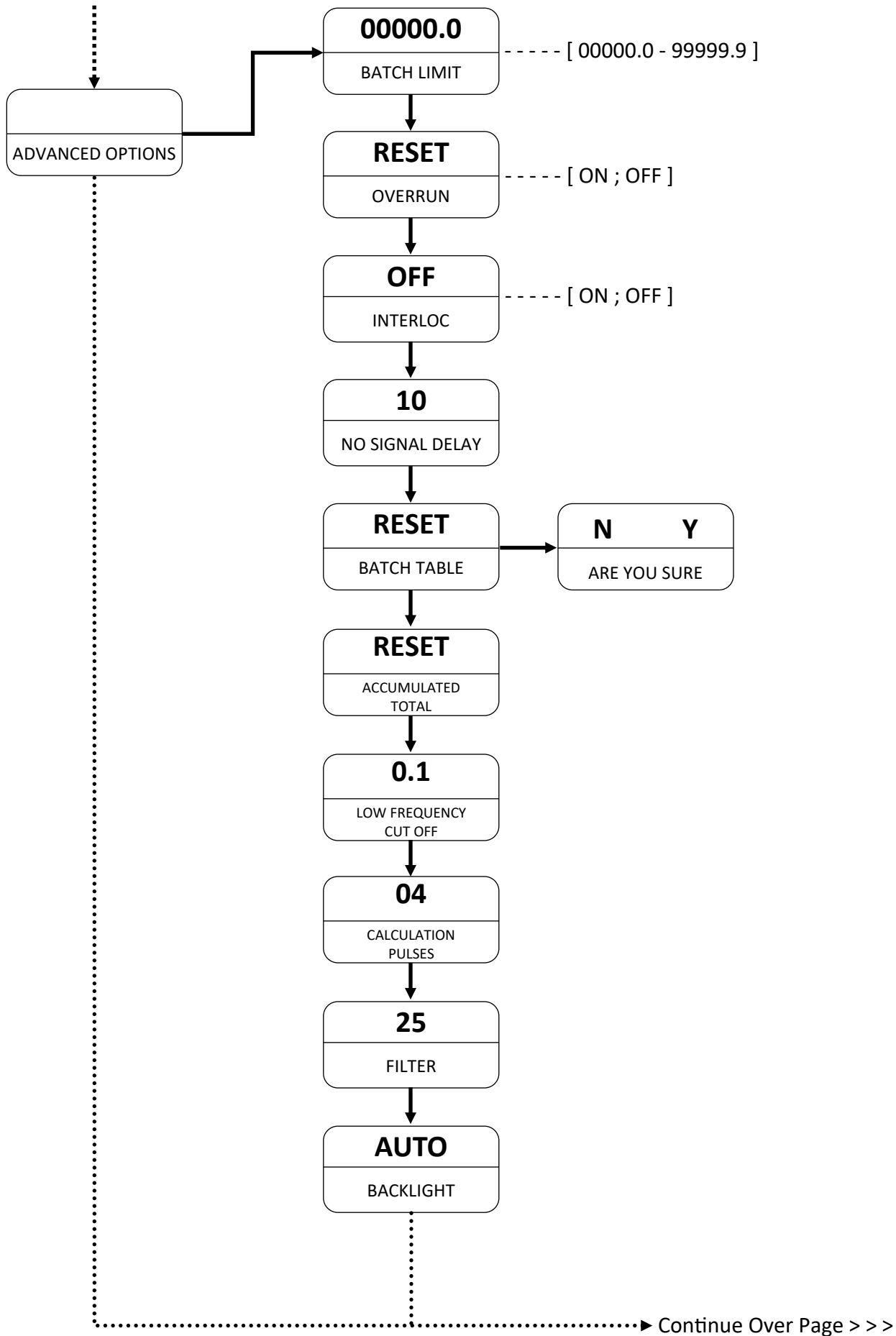

>>> From Previous Page

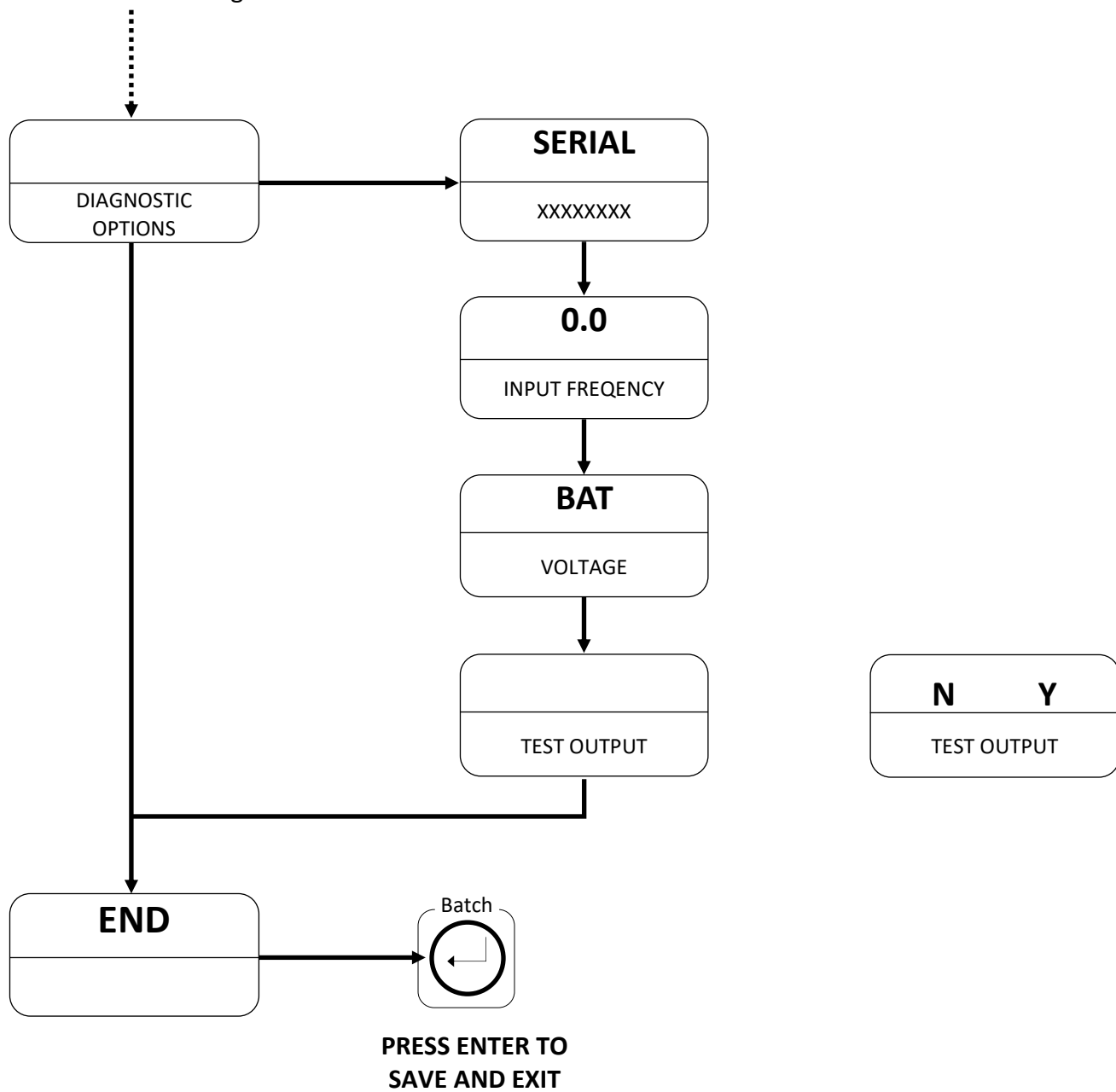

## Console Flow Meter Wiring

*The input type must be set in the software before the below wiring connections will function.*

NPN Sensor Input (Hall Effect) - OM Series and DP Series Flow Meters

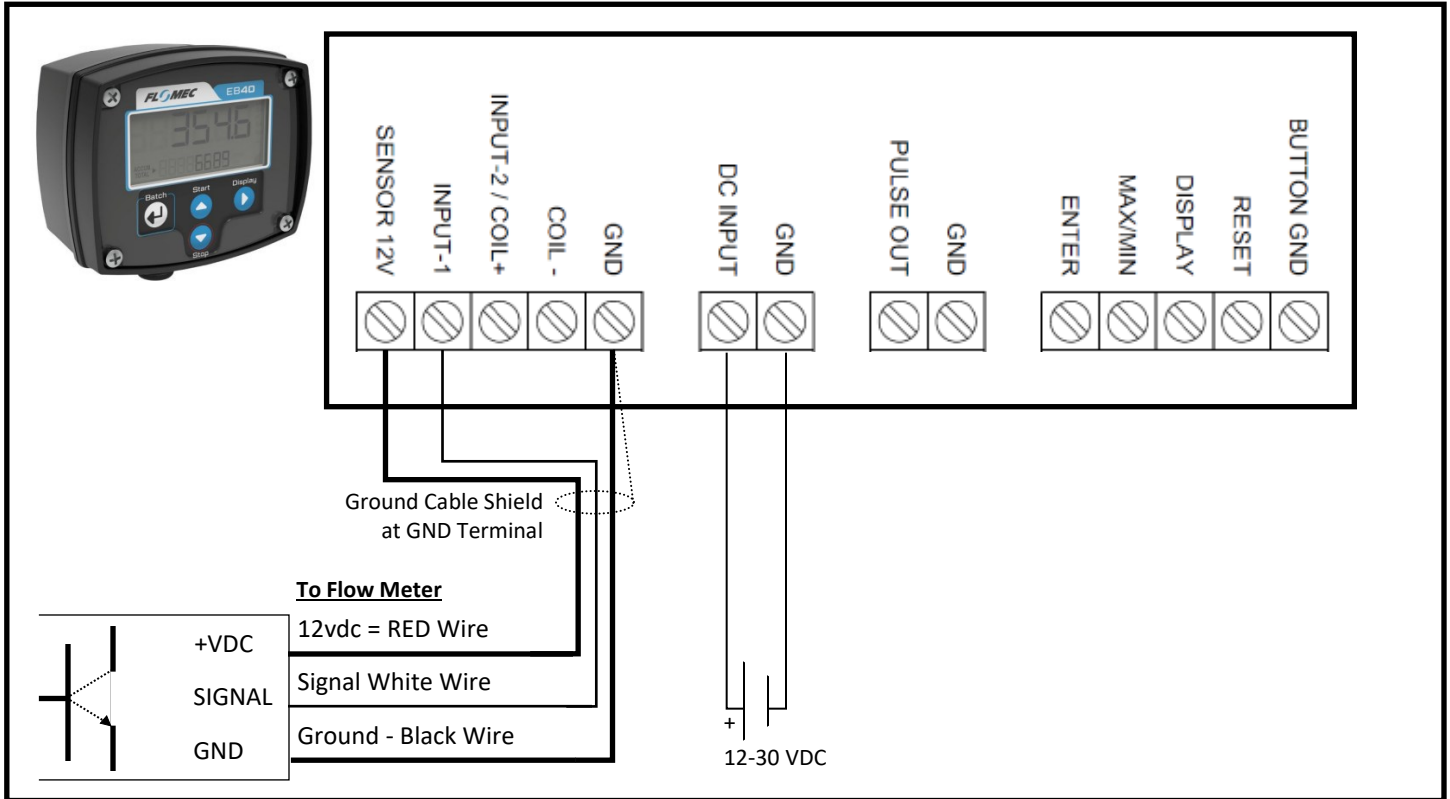

## Console Flow Meter Wiring

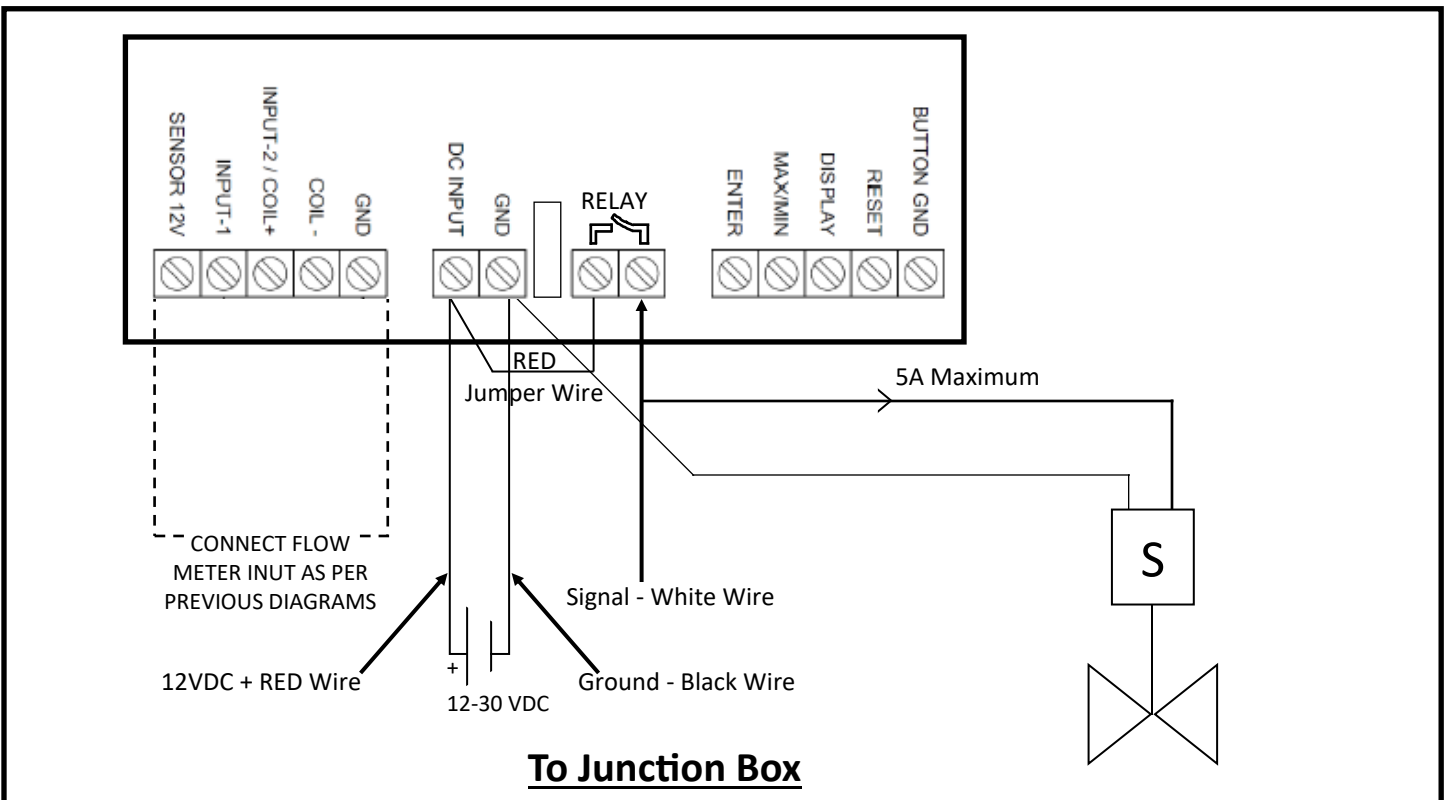



**Wiring Diagrams**

**Standard Pulse Output Board**

Applicable Models: 004, 006, 008, 015, 025, 040, 050

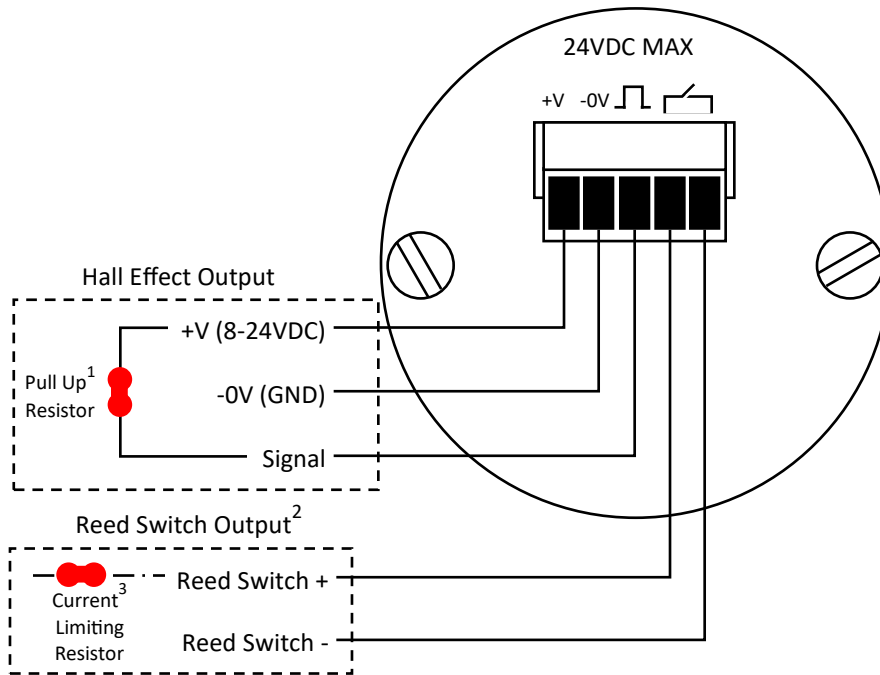

Model Prefix	025	040
Nominal Size	1" (25mm)	1.5" (40mm)
Flow Range <sup>2</sup> (USG/min)	2.6 ~ 40	4~66

## Junction Box Wiring

The STS-EZ-AUTOBATCH system conveniently centralizes the wiring in a junction box. The 12VDC power input, console control power and electric ball valve integrate in the junction box.

### Red Terminal

- Power Input 12VDC (+ Positive) Red Wire
- Electric Ball Valve (+ Positive) Red Wire
- Console (+ Positive) Red Wire

### Black Terminal

- Power Input 12VDC (- Ground) Black Wire
- Electric Ball Valve (- Ground) Black Wire
- Console (- Ground) Black Wire

### White Terminal

Electric Ball Valve (Signal) White Wire  
Console (Signal) White Wire

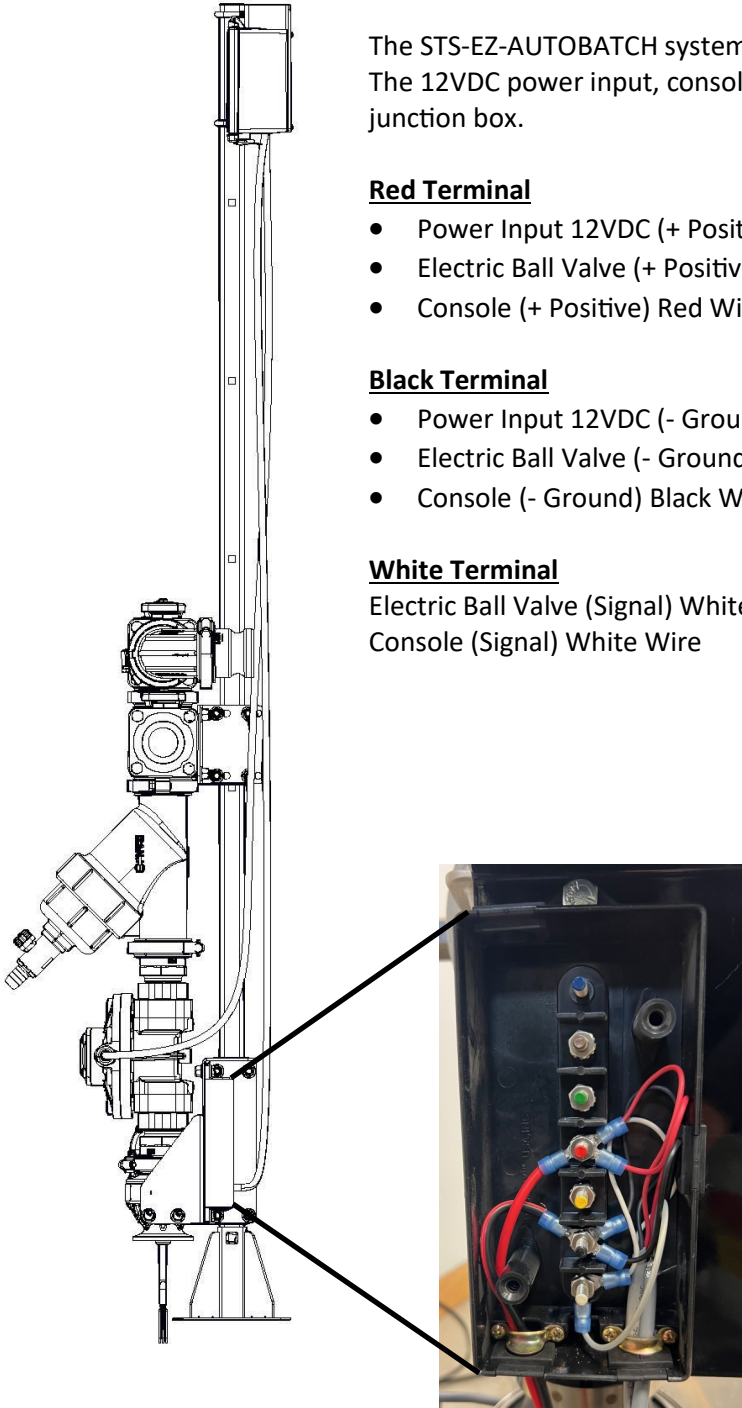

## Operating Principle

Oval Gear flowmeters are positive displacement devices where the passage of liquid causes two oval geared rotors to rotate within a precision measuring chamber. Each rotation of the Oval rotors will transmit 4 identical volumes of liquid from the meter inlet to outlet (as shown in the diagram below); providing electronic pulses via magnetic sensors to a digital instrument.

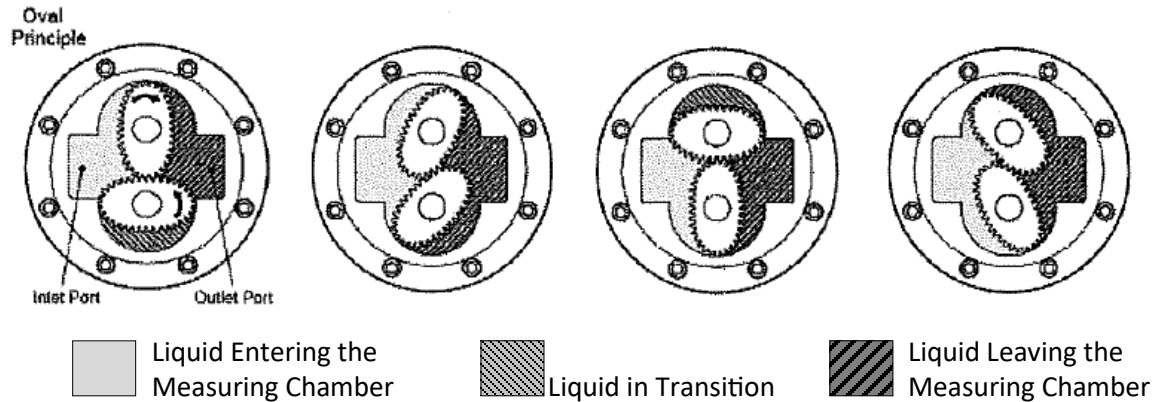

## Start Up Test Procedure

1. Before use, check the plumbing with water to insure no leaks and all fittings and gaskets are tight.
2. See STS Inductor Owners Manual for proper STS Inductor operation.
3. See Oval Gear flowmeter instruction manual for proper operation of the meter.
4. Attach bulk products to the input male quick coupler.
5. Slowly open the rinse valve to purge the manifold with water. Check for leaks.

**Note:** The Gear meter will register air. Important to purge the hose and plumbing of air in the lines.

## IMPORTANT

Properly label inputs to allow operator to easily identify.

## ⚠ WARNING

Operators need to have read and understand proper operation of STS INDUCTOR system before operating STS-EZ-AUTOBATCH System. Failure to do so can result in improper operation. Read and follow all instructions and have a complete understanding of each operation.

## STS-EZ-AUTOBATCH System Operation

(If using with other Inductor systems, make sure they are in proper operating modes. See their operation manual).

1. Turn 12VDC switch on (1), making sure the backlight and electric valve motor indicator light are illuminated (high light areas may be hard to see).
2. Check all calibration factors are entered correctly.
3. Once the system has been tested with water, make sure the rinse ball valve is closed.
4. Open chemical input valve.
5. Enter a batch volume or select from the pre-entered batch volumes (See pages 9 & 10 for full Batch Volume Instructions).
6. With desired volume displayed, to start adding product, press and hold the START (^) button for 2 seconds. The valve will open and the EB406-R will start counting.
7. Once desired volume is reached, the electric valve will close. The EB406-R has an Automatic Over-run Compensation feature which will measure the amount of over-run on previous batch volumes and automatically adjust the close timing of the valve on subsequent batch volumes. Batch controller can be expected to have accurate batch volumes from the second batch onwards. Automatic Over-run Compensation will remember the compensation amount, even after changing to a new batch preset value. So long as no physical changes are made to the system, the user should experience an accurate and consistent process. This feature can be turned off if it is not desired.
8. Once the batch has run, the console will display a message "press any button to continue".
9. Last run volume will auto-default, see step 5 to change volume.
10. To rinse at the end of the day, extended periods of non-use or to change chemicals, during the last fill after EZ-AUTOBATCH product has been added, close input (4) valve, open rinse (3) valve and run 5-10 gallons of fresh water through the column by selecting that batch volume (step 5) and running that batch volume through the system.

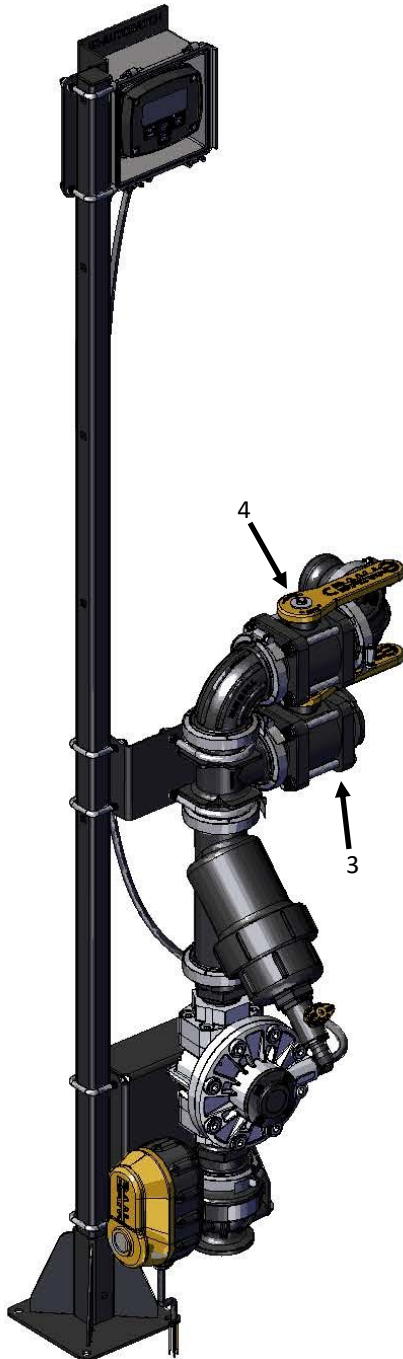

# Breakdown - STS-EZ-AUTOBATCH 100 (5283376)

Ref. #	Part #	Description	Qty
1	5283375	EZ-AUTOBATCH Base Plate Weldment	1
2	5070521-BLK	STS EZ-METER 1-1/2 Support Tube	1
3	5117343	3/8-16 x 0.75 Square Head Cup PT Set Screw	1
4	5046439	Tube Cap, 1-1/4" Square	1
5	5034159	5/16-18 x 1.3125 x 1.875 Square U-Bolt	6
6	5160007-BLK	EZ-AUTOBATCH Display Mount	1
7	5006389	5/16-18 Fling Top-Lock Hex Nut	14
8	5117357	#8-16 0.375 PH Round Head Screw	6
9	EB406-R	EB40 Easybatch w/5A Relay Control Console	1
10	5029249-BLK	RT40 Mounting Plate	1
11	5196031	Enclosure Box, 4.88 L x 4.88 W x 3.31 D	1
12	5043045	Cable Gland, M16 x .13-.27 Dia.	2
13	5043061	18/3 Shielded Cable-Gray PVC	2
14	5072277	1/2" & 3/4" Coupler Gasket (EPDM)	8
15	BJFC100	Banjo 1000 Series Manifold Flange Clamp-Worm Screw	8
16	M100SWP90	Banjo 1" Manifold Flng x 1" Flng Sweep, Elbow	2
17	MV100CF	Banjo 1" Full Port Manifold Ball Valve	2
18	M100A	Banjo 1" Manifold Flange x 1" Male Adapter	1
19	5160005-BLK	EZ-AUTOBATCH Tee Mount	1
20	M100TEE	Banjo 1" Manifold Flange Tee	1
21	UB100	Banjo 100 Series Manifold Flange Mounting U-Bolt	2
22	M100MPT	Banjo 1" Manifold Flange x 1" MPT	4
23	5116358	Banjo 1" Y Line Strainer w/20 Mesh Screen	1
24	LV038050MTLV	Banjo 3/8" FPT x 1/2" MPT Micro Valve	1
25	OM025P001-822	Flomec 1" PPS High Accuracy Flow Meter	1
26	5043046	Cable Gland, 1/2 MPT x .2-.35 dia.	1
27	5160004-BLK	EZ-AUTOBATCH Valve Mount	1
28	JB10-170	Junction Box, 7-Pole	1
29	5117323	5/16-18 x 0.75 Flng Hex Bolt	2
30	MEVX100	Banjo 1" Full Port MEVX Electric Valve	1
31	5034848	M8-1.25 x 16mm Serrated Flng Hex Bolt	2
32	5273295	Lead Wire Assembly, 8"	1
33	5277040	Lead Wire Assembly (14 ga, w/Switch), 120"	1
33.1	5157238	15 Amp Regular Blade Fuse	1

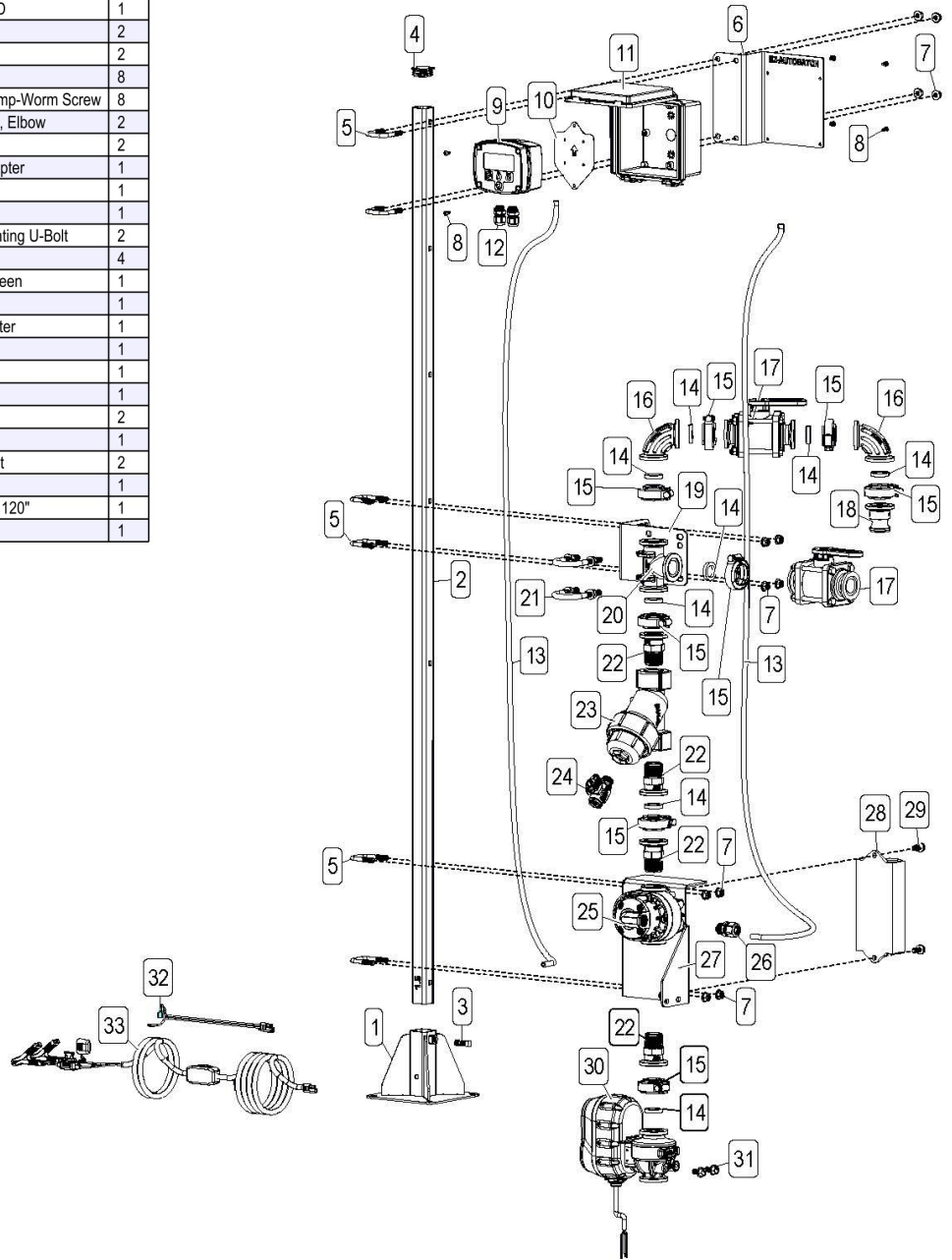

# Breakdown - STS-EZ-AUTOBATCH 150 (5283377)

Ref. #	Part #	Description	Qty
1	5283375-BLK	EZ-AUTOBATCH Base Plate Weldment	1
2	5070521-BLK	STS EZ-METER 1-1/2 Support Tube	1
3	5117343	3/8-16 x 0.75 Square Head Cup PT Set Screw	1
4	5046439	Tube Cap, 1-1/4" Square	1
5	5034159	5/16-18 x 1.3125 x 1.875 Square U-Bolt	6
6	5160007-BLK	EZ-AUTOBATCH Display Mount	1
7	5006389	5/16-18 Fling Top-Lock Hex Nut	14
8	5117357	#8-16 0.375 PH Round Head Screw	6
9	EB406-R	EB40 Easybatch w/5A Relay Control Console	1
10	5029249-BLK	TR40 Mounting Plate	1
11	5196031	Enclosure Box, 4.88 L x 4.88 W x 3.31 D	1
12	5043045	Cable Gland, M16 x .13-.27 Dia.	2
13	5043061	18/3 Shielded Cable-Gray PVC	2
14	5072215	1-1/2" EPDM Gasket	8
15	BJFC200	Banjo 2" Series Manifold Fling Clamp-Worm Screw	8
16	M200SWP90	Banjo 2" Flange Sweep - 90 Degree	2
17	MV200CF	Banjo 2" Manifold Flanged Ball Valve	2
18	M200A	Banjo 2" Manifold Flange x 2" Male Adapter	1
19	5160005-BLK	EZ-AUTOBATCH Tee Mount	1
20	M200TEE	Banjo 2" Manifold Flange Tee	1
21	UB202	Banjo 200 Series Manifold Flange Mounting U-Bolt	2
22	M200150MPT	Banjo 2" Manifold Flange x 1-1/2" MPT	2
23	MLS20020	Banjo 2" Y Line Strainer w/20Mesh Screen	1
24	LVHB075100MTLV	Banjo 3/4" HB x 1" MNPT Micro Valve	1
25	5167114	1-1/2" PPS High Accuracy Flow Meter	1
26	5043046	Cable Gland, 1/2 MPT x .2-.35 Dia.	1
27	5160004-BLK	EZ-AUTOBATCH Valve Mount	1
28	JB10-170	Junction Box, 7-Pole	1
29	5117323	5/16-18 x 0.75 Fling Hex Bolt	2
30	MEVX200	Banjo 2" Standard Port MEVX Electric Valve	1
31	5034848	M8-1.25 x 16mm Serrated Fling Hex Bolt	2
32	5273295	Lead Wire Assembly, 8"	1
33	5277040	Lead Wire Assembly (14 ga, w/Switch), 120"	1
33.1	5157238	15 Amp Regular Blade Fuse	1

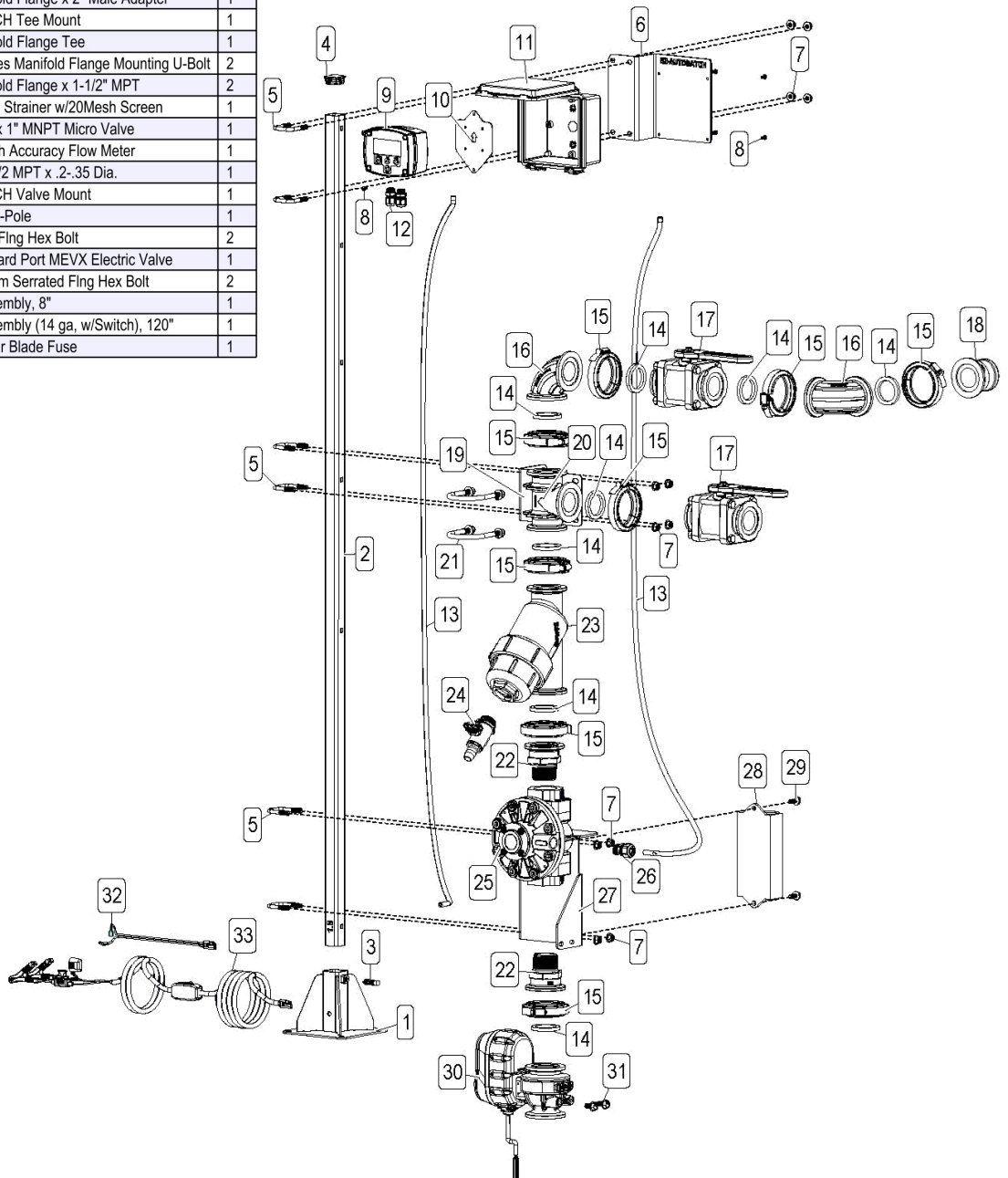

# Warranty

## LIMITED WARRANTY FOR NEW AG SPRAY EQUIPMENT

**WHO MAY USE THIS LIMITED WARRANTY.** This limited warranty (the "Limited Warranty") is provided by Ag Spray Equipment to the original purchaser ("you") of the Equipment (as defined below) from Ag Spray Equipment or one of Ag Spray Equipment's authorized dealers. This Limited Warranty does not apply to any subsequent owner or other transferee of the Equipment. THIS LIMITED WARRANTY GIVES YOU SPECIFIC LEGAL RIGHTS, AND YOU MAY ALSO HAVE OTHER RIGHTS WHICH VARY FROM STATE TO STATE.

**WHAT THIS LIMITED WARRANTY COVERS AND FOR HOW LONG.** Ag Spray Equipment warrants that any new Equipment will be free from defects in material and workmanship for a period of **one (1) year** (homeowner), **90 days** (commercial user), after delivery of the Equipment to you (the "Warranty Period"). The Warranty Period is not extended if Ag Spray Equipment repairs or replaces the Equipment.

**WHAT IS NOT COVERED BY THIS LIMITED WARRANTY.** This Limited Warranty does not apply to: (1) used Equipment; (2) any Equipment that has been altered, changed, repaired or treated since its delivery to you, other than by Ag Spray Equipment or its authorized dealers; (3) damage or depreciation due to normal wear and tear; (4) defects or damage due to failure to follow Ag Spray Equipment's operator's manual, specifications or other written instructions, or improper storage, operation, maintenance, application or installation of parts; (5) defects or damage due to misuse, accident or neglect, "acts of God" or other events beyond Ag Spray Equipment's reasonable control; (6) accessories, attachments, tools or parts that were not manufactured by Ag Spray Equipment, whether or not sold or operated with the Equipment; or (7) rubber parts, such as tires, hoses and grommets.

**HOW TO OBTAIN WARRANTY SERVICE.** To obtain warranty service under this Limited Warranty, you must (1) provide written notice to Ag Spray Equipment of the defect during the Warranty Period and within **thirty (30)** days after the defect becomes apparent or the repair becomes necessary, at the following address: Ag Spray Equipment, 1000 Fimco Lane, North Sioux City, SD 57049; and (2) make the Equipment available to Ag Spray Equipment or an authorized dealer within a reasonable period of time. For more information about this Limited Warranty, please call: **800-274-1025** or your local Ag Spray location.

**WHAT REMEDIES ARE AVAILABLE UNDER THIS LIMITED WARRANTY.** If the conditions set forth above are fulfilled and the Equipment or any part thereof is found to be defective, Ag Spray Equipment shall, at its own cost, and at its option, either repair or replace the defective Equipment or part. Ag Spray Equipment will pay for shipping and handling fees to return the repaired or replacement Equipment or part to you.

**LIMITATION OF IMPLIED WARRANTIES AND OTHER REMEDIES.** THE REMEDIES DESCRIBED ABOVE ARE YOUR SOLE AND EXCLUSIVE REMEDIES, AND AG SPRAY EQUIPMENT'S SOLE LIABILITY, FOR ANY BREACH OF THIS LIMITED WARRANTY. TO THE EXTENT APPLICABLE, ANY IMPLIED WARRANTIES, INCLUDING, WITHOUT LIMITATION, THE IMPLIED WARRANTIES OF MERCHANTABILITY AND FITNESS FOR A PARTICULAR PURPOSE, SHALL BE LIMITED IN DURATION TO THE WARRANTY PERIOD, AND THE REMEDIES AVAILABLE FOR BREACH THEREOF SHALL BE LIMITED TO THE REMEDIES AVAILABLE UNDER THIS EXPRESS LIMITED WARRANTY. SOME STATES DO NOT ALLOW LIMITATIONS ON HOW LONG AN IMPLIED WARRANTY LASTS, SO THE ABOVE LIMITATION MAY NOT APPLY TO YOU. IN NO EVENT SHALL AG SPRAY EQUIPMENT'S LIABILITY UNDER THIS LIMITED WARRANTY EXCEED THE ACTUAL AMOUNT PAID BY YOU FOR THE DEFECTIVE EQUIPMENT, NOR SHALL AG SPRAY EQUIPMENT BE LIABLE, UNDER ANY CIRCUMSTANCES, FOR ANY CONSEQUENTIAL, INCIDENTAL, SPECIAL OR PUNITIVE DAMAGES OR LOSSES, WHETHER DIRECT OR INDIRECT. SOME STATES DO NOT ALLOW THE EXCLUSION OR LIMITATION OF INCIDENTAL OR CONSEQUENTIAL DAMAGES, SO THE ABOVE LIMITATION OR EXCLUSION MAY NOT APPLY TO YOU.